

6600 SERIES

PUSH-PULL LATCH WITH MORTISE LOCK



**STANDARD MORTISE
LOCK DOOR PREP
NO ADDITIONAL PREP FOR TRIM**

US Patent No. 5,730,478
6,196,599

ABH	GLYNN - JOHNSON	FUNCTION
6610	HL6-9010	PASSAGE
6632	HL6-9040	PRIVACY
6637	HL6-9466	STORAGE-UTILITY ROOM
6638	HL6-9060	APARTMENT ENTRANCE
6641	HL6-9082	INSTITUTION
6645	HL6-9485	HOTEL
6653	HL6-9453	ENTRANCE
6654	HL6-9473	DORMITORY-BEDROOM
6656	HL6-9070	CLASSROOM
6657	HL6-9456	DORMITORY-EXIT
6658	HL6-9080	STOREROOM

† **NOTE:** ABH does not provide cylinders. When cylinders are used, the handles **MUST** be mounted in the down or horizontal positions on the cylinder side. Horizontal mounting required when thumb turn is used (or use "J" series).

*When ordering **engraved** models, add the letter **P** after the numbers shown above. Designate hand and how handles are to be mounted (i.e, Push-up, Pull-down).

- Wide selection of functions.
- Handed—specify when ordering*.
- Push/pull trim can be mounted with the handles up, down or horizontal. When using cylinders, **ONLY** down or horizontal handles can be used. **SEE NOTE †.**
- Standard 2 3/4" backset latches.
- Includes all required fasteners.
- Compact non-handed covers provide maximum clearance between the handle and door for easy operation in any application.
- UL listed for all fire doors.
- Available in BHMA finishes.
- Lead lining is available.
- Meets ADA requirements.
- Standard for 1 3/4" thick doors
- 3/4" latch throw

ABH®

**6600 SERIES PUSH/PULL TRIM
WITH MORTISE LOCK**

c  US
LISTED

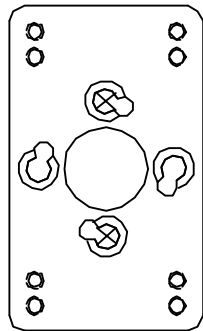
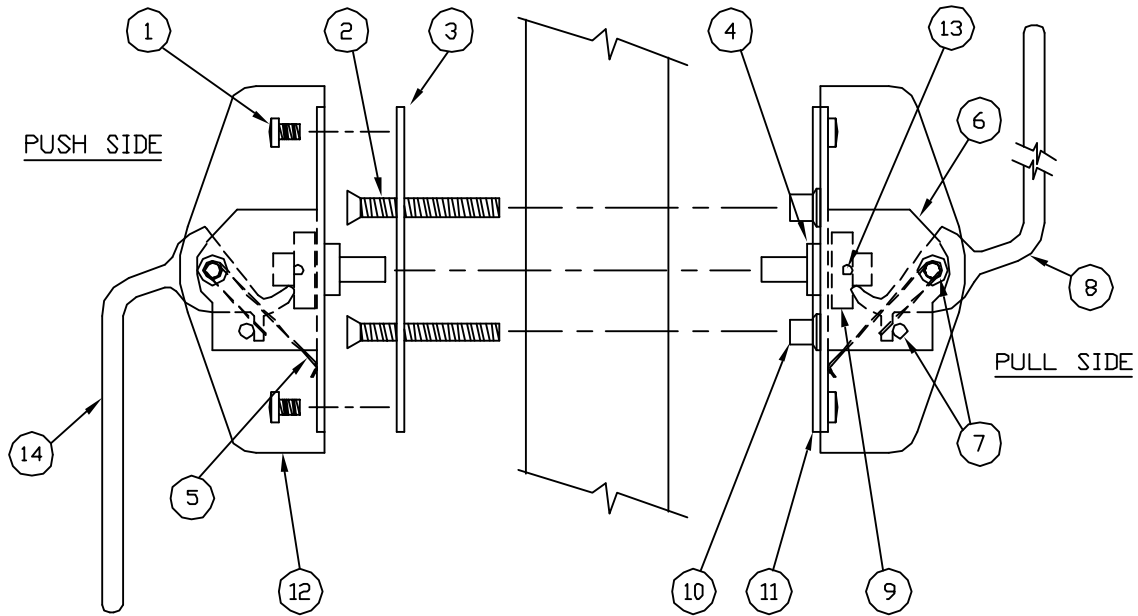

VERTICAL MOUNT

PULL SIDE
ADAPTER PLATE

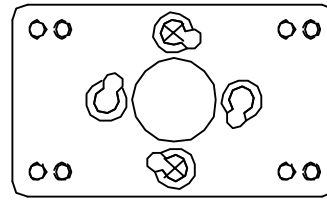









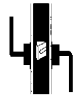
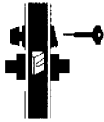

HORIZONTAL MOUNT

 LOCK NUT (ITEM 10) POSITIONS

PULL SIDE HANDLE SHIPPED FROM FACTORY WITH ADAPTER PLATE
ASSEMBLED FOR VERTICAL MOUNTING

ITEM	QTY	PART	ITEM	QTY	PART
1	8	10-32 X 1/4" PAN HD. M.S.	9	2	CAM ASSEMBLY
2	2	12-24 X 1-7/8" F.H.M.S.	10	2	12-24 LOCK NUT
3	1	PUSH SIDE ADAPTER PLATE	11	1	PULL SIDE ADAPTER PLATE
4	2EA	WASHERS & C-RING	12	2	COVER
5	2	SPRING	13	4	8-32 X 3/8" F.H.M.S.
6	2	MOUNTING BRACKET	14	1	PUSH SIDE HANDLE
7	4EA	HANDLE SHAFT & COTTER PIN			
8	1	PULL SIDE HANDLE			

6600 SERIES FUNCTION

Cat. No.	Function	Description	ANSI No. & Grade
6610		Passage/Closet Latchset Latch bolt by handles at all times.	F01-1 F01 -2
6632		Privacy Lock* Latch bolt operated by handles from either side except when outside handle is locked by inside T-turn. Operating inside handle, closing door or operating outside emergency release unlocks outside handle. Emergency tool furnished with lock.	F22-1 F22-2
6637		Store Door Lock Latch bolt by handles. Dead bolt by key from either side.	F14-1 F14-2
6638		Entry/Restroom Lock Deadlocking latch bolt by handles except when outside handle is locked by key inside, then by key outside.	F09-1 F09-2
6641		Asylum Lock Deadlocking latch bolt by key from either side. Both handles rigid.	F30
6645		Hotel/Motel Lock* Deadlocking latch bolt by inside handle or key outside. Outside handle rigid. Dead bolt by turn inside or emergency key outside. Projecting dead bolt displays occupancy indicator and shuts out all keys except emergency. Activating inside handle retracts both bolts.	F15-1 F15-2
6653		Entry/Office Lock* Latch bolt by handles except when outside handle is made inoperative by buttons in face. Dead bolt by key outside and turn inside. Activating inside handle retracts both bolts. Deadlocking latch.	F10-1 F10-2 F12-1 F12-2 F20-1 F20-2
6654		Entry/Office Lock* Latch bolt by handles. Dead bolt by key outside or handle inside.	F21 -1 F21 -2
6656		Classroom Lock Deadlocking latch bolt by handles. Outside handle locked by key outside. inside handle always free.	F05-1 F05-2
6657		Dormitory Lock* Latch bolt by handles except when outside handle is locked by projecting dead bolt. Key outside retracts dead bolt and unlocks outside handle. Activating inside handle retracts both bolts.	F13-1 F13-2
6658		Storeroom/Exit Lock Deadlocking latch bolt by inside handle or key outside. Outside handle rigid.	F07-1 F07-2

* For sides with thumb turn or emergency key, handles must be mounted horizontally or J Series must be used.

